



## 7 Pipwell Gate, Moulton Seas End, PE12 6LU

**£140,000**

- Popular village setting
- Good size rear garden
- Cottage with charm and character
- Two double bedrooms
- Spacious reception rooms
- Downstairs bathroom
- Off street parking
- Sold with no chain!

Located in the popular village of Moulton Seas End, this lovely and quaint cottage offers a welcoming layout and plenty of character.

The ground floor flows beautifully, with generously sized reception rooms providing comfortable living space, while the kitchen overlooks a good-sized rear garden, perfect for relaxing or entertaining.

Upstairs, the property has a true cottage feel and features two spacious double bedrooms, creating a cosy and inviting atmosphere throughout.

Sold with no chain!

Interested in viewing this charming home? Contact us today to book your appointment!

### Entrance Hall



Door to side. Window to side. Doors to kitchen, bathroom and opening to dining room.

### Bathroom 6'8" x 5'6" (2.04m x 1.69m)



Panelled bath with shower over. Wash hand basin. Toilet. Partially tiled walls.

### Kitchen 7'9" x 9'4" (2.38m x 2.87m)



Window to rear. Matching range of base and eye level units. Sink unit with drainer and mixer tap. Space for free standing cooker. Space for fridge/freezer. Space and plumbing for washing machine.

**Dining Room 9'1" x 10'8" (2.77m x 3.26m)**



Stairs to first floor landing. Opening to lounge.

**Lounge 10'11" x 13'5" (3.34m x 4.10m)**



Window to front. Fire surround for electric fire.

**First Floor Landing**

Doors to bedrooms.

**Bedroom 1 10'11" x 13'5" (3.34m x 4.10m)**



Window to front.

**Bedroom 2 9'0" x 10'9" (2.75m x 3.29m)**



Window to rear. Built in cupboard housing hot water cylinder.

**Outside**

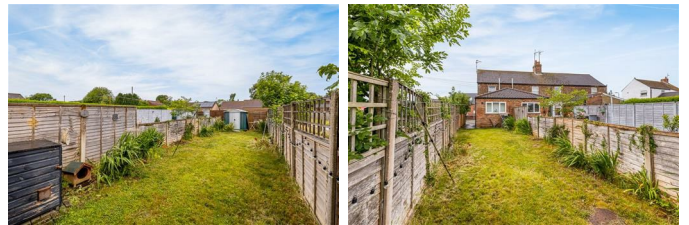

The rear garden is enclosed by timber fencing. Lawn area with shrub borders.

**Property Postcode**

For location purposes the postcode of this property is: PE12 6LU

**Additional Information**

PLEASE NOTE:

All photos are property of Ark Property Centre and can not be used without their explicit permission.

**Anti-money Laundering (AML) Checks**

If you wish to proceed with an offer on this property, we are required under HMRC regulations to carry out anti-money laundering (AML) checks for all prospective buyers and sellers. We take this responsibility seriously and ensure that all checks are conducted securely and in line with current guidelines. To facilitate this process, our trusted partner, Coadjute, will manage the verification on our behalf. Once an offer has been accepted (subject to contract), Coadjute will send you a secure link to complete the biometric identification checks electronically.

Please note that a non-refundable fee of £27 + VAT per person applies for this service, with payment processed directly through Coadjute.

These AML checks must be completed before we are able to issue the memorandum of sale to the solicitors confirming the transaction. If you have any questions regarding this process, please do not hesitate to contact our office.

### Verified Material Information

Tenure: Freehold

Council tax band: A

Annual charge: No

Property construction: Brick built

Electricity supply: Eon

Solar Panels: No

Other electricity sources: No

Water supply: Anglian Water

Sewerage: Septic tank

Heating: Electric heating

Heating features: No

Broadband: As stated by Ofcom, Standard, Superfast and Ultrafast is available.

Mobile coverage: As stated by Ofcom, Indoor - EE is Likely over Voice and Data. Three is Limited over Voice and Data. O2 is Limited over Voice and Data. Vodafone is Limited over Voice and Data.

Mobile coverage: As stated by Ofcom, Outdoor - EE is Likely over Voice and Data. Three is Likely over Voice and Data, O2 is Likely over Voice and Data. Vodafone is Likely over Voice and Data.

Parking: Car park to the rear

Building safety issues: No

Restrictions: No

Public right of way: No

Flood risk: Surface water - low. Rivers and the sea - medium. Other flood risks - Groundwater - flooding from groundwater is unlikely in this area. Reservoirs - flooding from reservoirs is unlikely in this area.

Coastal erosion risk: No

Planning permission: Please refer to South Holland District Council Planning Portal for any planning applications.

Accessibility and adaptations: No

Coalfield or mining area: No

Energy Performance rating: TBC

### Viewing Arrangements

Viewing is by appointment with Ark Property Centre

only. We suggest you call our office for full information about this property before arranging a viewing.

### Offer Procedure

Please note: before an offer is agreed on a property you will be asked to provide I.D and proof of finance, in compliance Money Laundering Regulations 2017 (MLR 2017). The business will perform a Money Laundering Check as part of its Money Laundering Policy.

If a cash offer is made, which is not subject to the sale of a property, proof of funds will be requested or confirmation of available funds from your solicitor.

### Ark Property Centre

If you are thinking about selling your property or are not happy with your current agent - we can offer a FREE valuation service with no obligation.

### Referral & Fee Disclosure

We can also offer full Financial and Solicitor services.

We have strong relationships with a panel of trusted solicitors and mortgage advisors. Because we refer a high volume of work to them, they're able to provide our clients with preferential service and competitive rates. If we introduce you to one of these solicitors or mortgage advisors, we may receive a referral fee of between £100 and £250. We only work with firms we trust to deliver high-quality advice and good value. You are free to use any solicitor or mortgage advisor you choose, but we hope you find our recommended panel competitive and helpful.

### Disclaimer

These particulars, whilst believed to be accurate are set out as general outline only for guidance and do not constitute any part of an offer or contract. Intending purchasers should not rely on them as statements of representation of fact, but must satisfy themselves by inspection or otherwise as to their accuracy. No person in this firm's employment has authority to make or give representation or warranty in respect of the property. These details are subject to change.

## Floor Plan

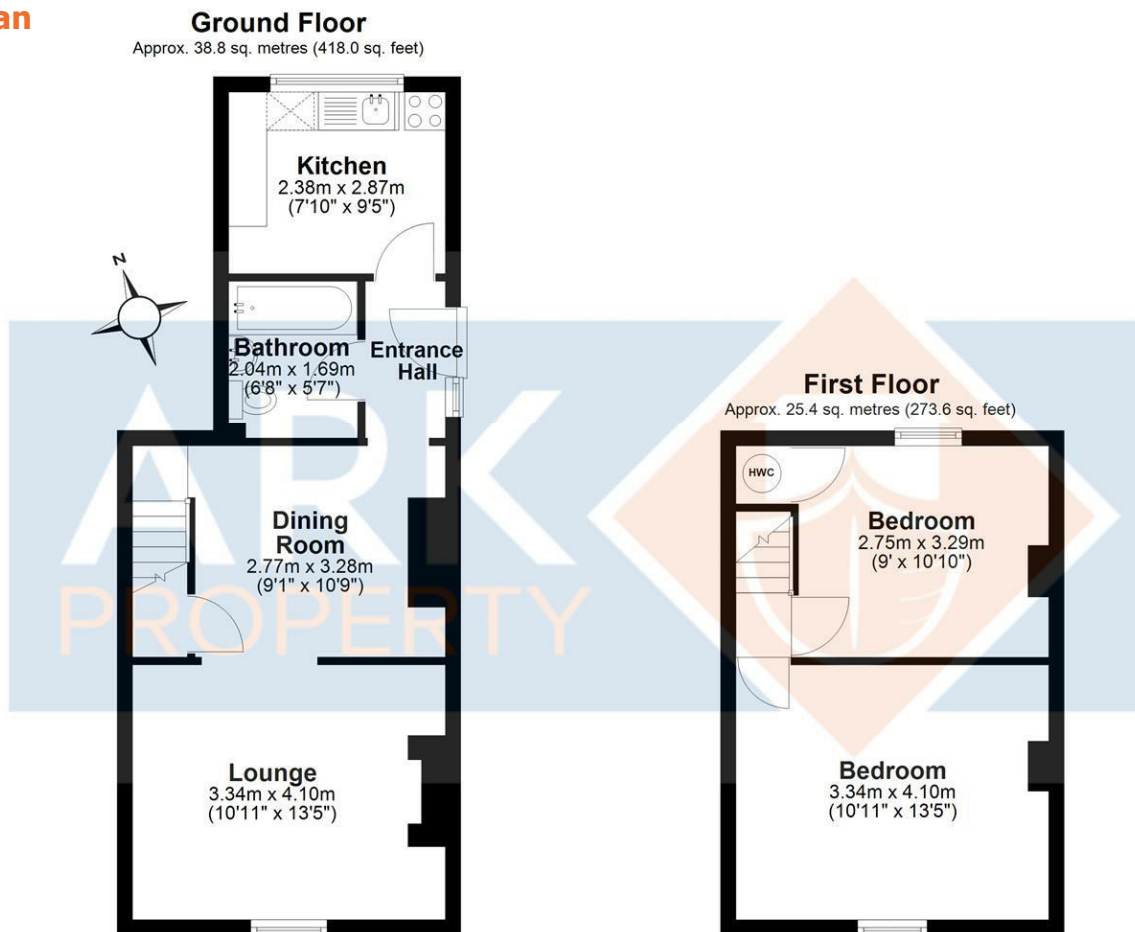

Total area: approx. 64.3 sq. metres (691.7 sq. feet)

Floor plan created by Matte Black Media.  
Plan produced using PlanUp.

## Area Map

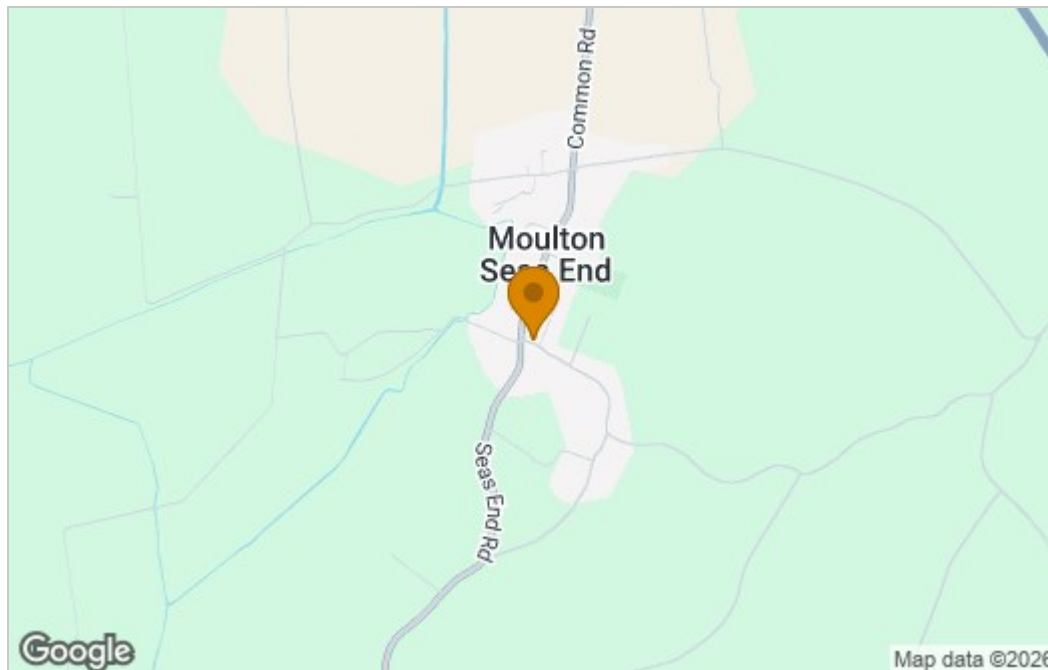

## Energy Efficiency Graph

Energy Efficiency Rating		Current	Potential
Very energy efficient - lower running costs			
(92 plus) <b>A</b>			
(81-91) <b>B</b>			
(69-80) <b>C</b>			
(55-68) <b>D</b>			
(39-54) <b>E</b>			
(21-38) <b>F</b>			
(1-20) <b>G</b>			
Not energy efficient - higher running costs			
<b>England &amp; Wales</b>		EU Directive 2002/91/EC	

Environmental Impact (CO <sub>2</sub> ) Rating		Current	Potential
Very environmentally friendly - lower CO <sub>2</sub> emissions			
(92 plus) <b>A</b>			
(81-91) <b>B</b>			
(69-80) <b>C</b>			
(55-68) <b>D</b>			
(39-54) <b>E</b>			
(21-38) <b>F</b>			
(1-20) <b>G</b>			
Not environmentally friendly - higher CO <sub>2</sub> emissions			
<b>England &amp; Wales</b>		EU Directive 2002/91/EC	

These particulars, whilst believed to be accurate are set out as a general outline only for guidance and do not constitute any part of an offer or contract. Intending purchasers should not rely on them as statements of representation of fact, but must satisfy themselves by inspection or otherwise as to their accuracy. No person in this firm's employment has the authority to make or give any representation or warranty in respect of the property.

6 New Road, Spalding, Lincolnshire, PE11 1DQ

Tel: 01775 766888 Email: info@arkpropertycentre.co.uk <https://www.arkpropertycentre.co.uk>

