



John Harrison Way Holbeach PE12 7JH

£254,950

- Three bedroom detached house
- Two reception rooms
- En-suite to master bedroom
- Single garage with ample parking
- End of cul de sac location
- Kitchen with utility room
- Enclosed rear garden
- Viewing essential!

THE PROPERTY

Offered to market is this 3 bedroom detached home on John Harrison Way, situated on a quiet cul de sac. The property is versatile in its layout and would suit couples and families alike. Offering 3 bedrooms, one en-suite and family bathroom to the first floor. Downstairs you will find an entrance hall, cloakroom, lounge, dining room and kitchen with utility room. Outside there is ample parking in front of the single garage and enclosed rear garden, perfect for entertaining.

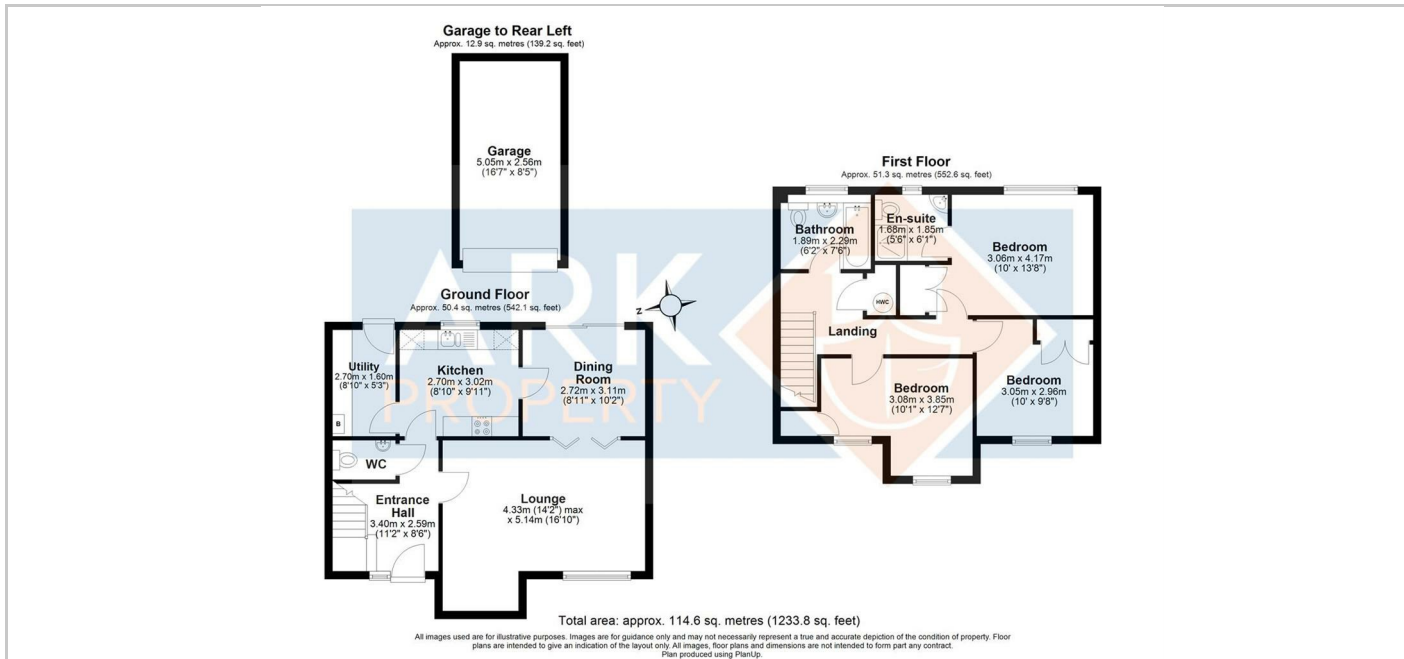

SITUATION

Directions

6 New Road, Spalding, Lincolnshire, PE11 1DQ
Tel: 01775 766888 Email: info@arkpropertycentre.co.uk <https://www.arkpropertycentre.co.uk>

